

Township N: 35 North, Range N: 7 West 2<sup>nd</sup> Mer.

PORTAGE TOWNSHIP

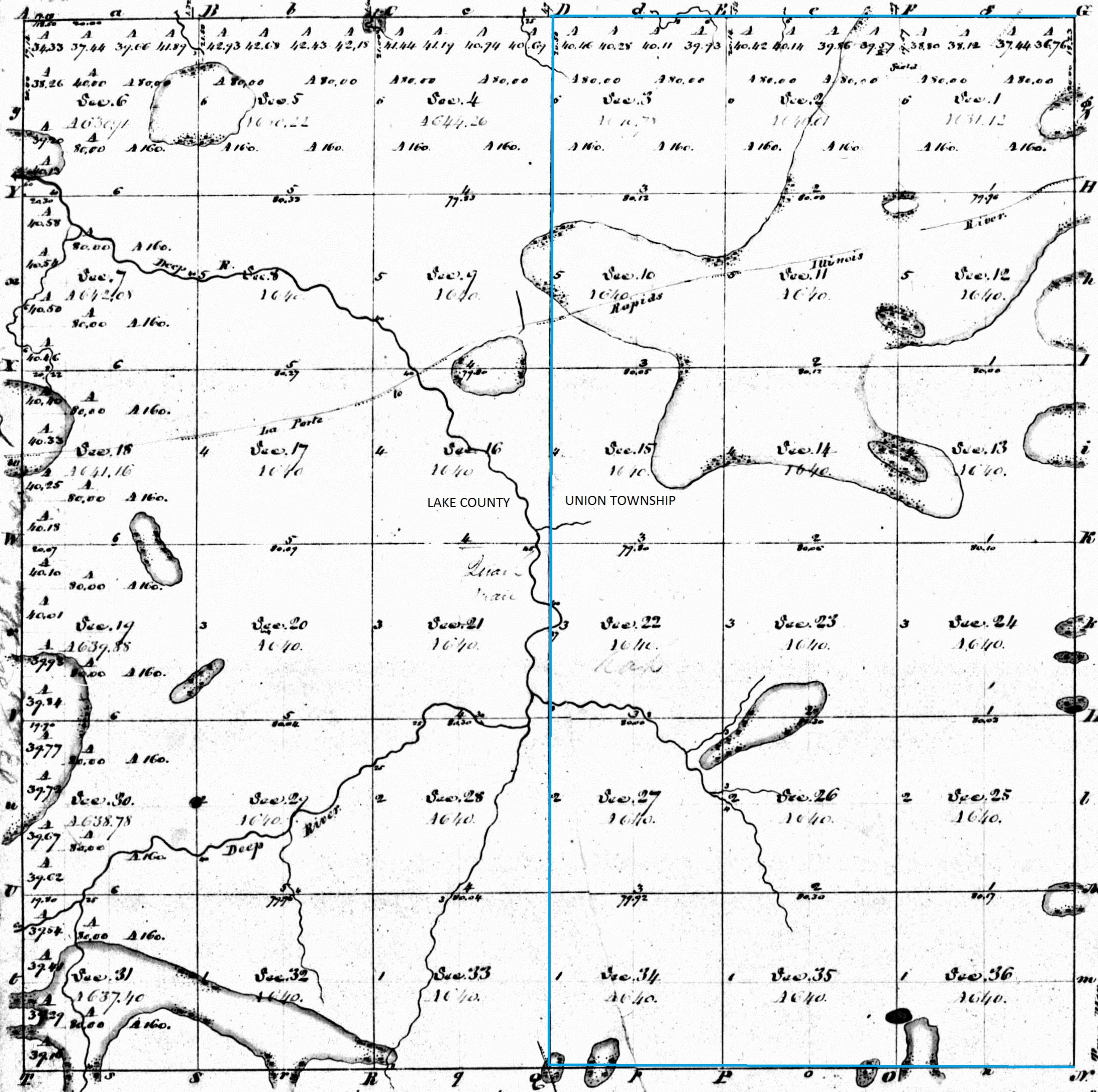

INDIANA  
N & W 2 P.M.

Annotated by Steven R. Shook, December 2013

Total number of Acres 23,076.60

PORTER TOWNSHIP

Scale 4000' to an Inch.

Survey Designated	By whom surveyed	Date of contract	Acres of Survey	When surveyed	Map or plat on file
Subdivisions	Andrew Bunker	April 21, 1832	60.03.00	3 <sup>rd</sup> of 1834 1 <sup>st</sup> of 1836	
Town lines	Sibley & Clarke	27, 1833	23.72.10	1 <sup>st</sup> of 1834 2 <sup>d</sup> of 1834	

The above Map, of Townships N: 35 North, Range N: 7 West 2<sup>nd</sup> Meridian, (Indiana) is strictly conformable to the field notes of the Survey thereof on file in this Office, which have been examined and approved.  
Surveyor General's Office  
Cincinnati April 26<sup>th</sup> 1836  
Robt. T. Suttle, Sur. Genl.

33  
*[Handwritten signature]*



Township 13<sup>th</sup> North, Range 1<sup>st</sup> West 2<sup>nd</sup> Mer.

PORTAGE TOWNSHIP

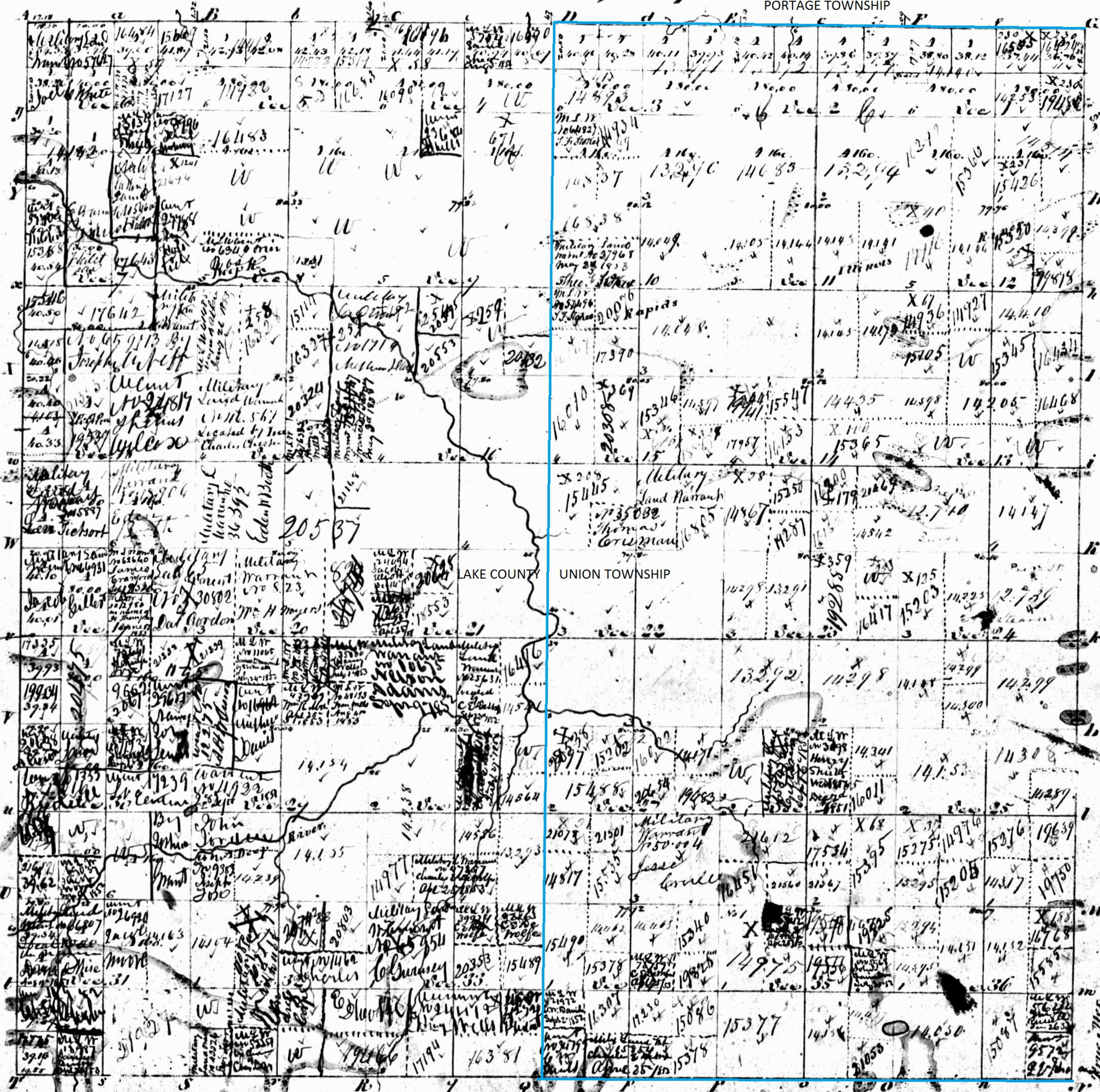

Offered at Public Sale this 2<sup>nd</sup> day of March, 1854  
from Section 20, to be 36 and 37 Section 20

State Act 28<sup>th</sup> September, 1850. Sec 11.

Annotated by Steven R. Shook, December 2013

PORTER TOWNSHIP

Surveyed in 1834 by Andrew Kinniside

This above map is truly copied from  
the Original on file in this Office  
Surveyor General's Office  
Cincinnati, April 25<sup>th</sup> 1896. *B.S.H. & Co.*